

REVISIONS				
ECN	REV.	DESCRIPTION	DATE	APPROVED
	A	RELEASE FOR PRODUCTION	05-29-08	
	B	UPDATE DRAWING	05-05-20	
21017	C	UPDATED TO PG11 GLAND UPDATE MATERIAL THICKNESS	03-31-21	

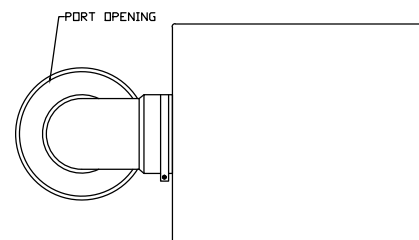

NOTES:

- 1: MATERIAL - 5052 ALUMINUM
UNLESS OTHERWISE SPECIFIED
- 2: FINISH - STUDIO BLACK POWDER COAT
UNLESS OTHERWISE SPECIFIED
- 3: MARINE GRADE
- 4: IMPEDANCE - 4 OHMS

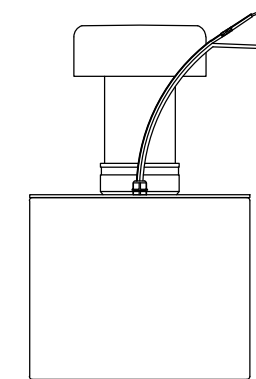
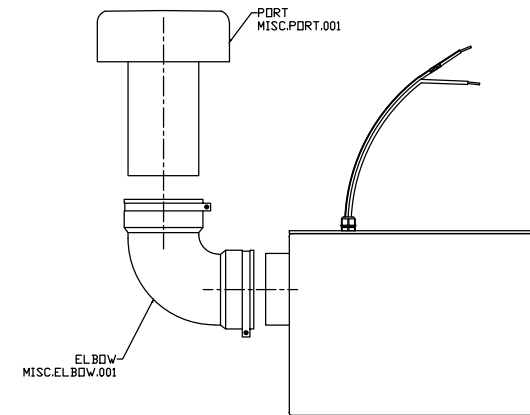
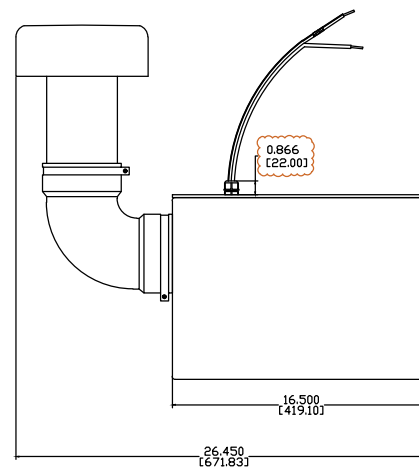
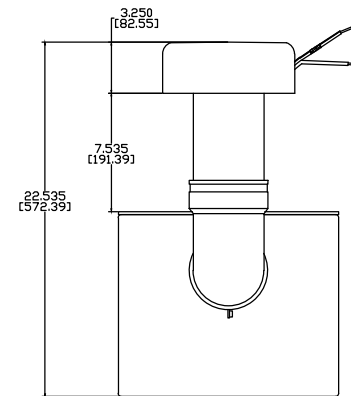
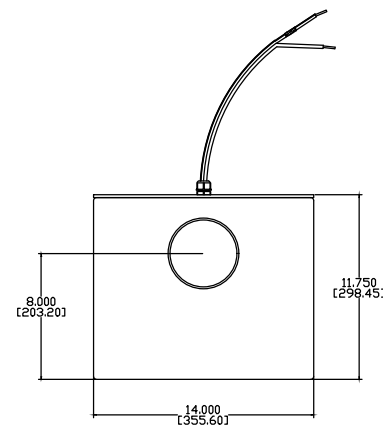
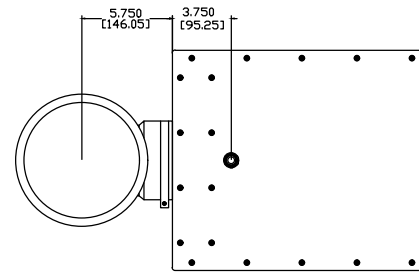
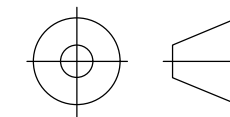

"THIRD ANGLE" PROJECTION

PROPRIETARY INFORMATION
THE DESIGNS, INFORMATION, AND
DATA CONTAINED HEREIN ARE
PROPRIETARY AND ARE SUBMITTED
IN CONFIDENCE, AND SHALL NOT BE
DISCLOSED, USED OR DUPLICATED
IN WHOLE OR IN PART, FOR ANY
PURPOSES WHATSOEVER, WITHOUT
THE PRIOR WRITTEN PERMISSION OF
JAMES LOUDSPEAKER LLC, 2185
PARK PL, MINDEN, NV 89423. THIS
LEGEND SHALL BE MARKED ON ANY
REPRODUCTIONS HEREOF IN WHOLE
OR IN PART. RECEIPT OF THIS
DOCUMENT SHALL BE DEEMED TO
BE AN ACCEPTANCE OF THE
CONDITIONS SPECIFIED HEREIN.

JAMES LOUDSPEAKER

ST12

EXTERNAL DIMENSIONS

P/N: -

DWR #: 080529-A00

REVISED BY: M. GARCIA

DRAWN BY: M. PARK

DATE: 05-29-08

APPROVED:

DRAFTING APPROVED:

SCALE:

TOLERANCES: ANG: ± = .5° FRACT. ± = 1/32
DECIMALS: .XX ± = .01 .XXX ± = .005

REVISION: A

SHEET 1 OF 4